

## INSTALLATION INSTRUCTION

- 1.The fixture is for 7W / 9W LED,(700mA) and 13W / 14W LED,(1050mA).
- 2.Before installation, make sure that the power supply is off.
- 3.Follow the steps as down below for installation or replacement of bulb.
- 4.After finishing every step, tighten the screws, have the fixture fixed, then connect the power supply.
- 5.It is recommended that these products are installed by a qualified electrician.

### Assembling diagram:

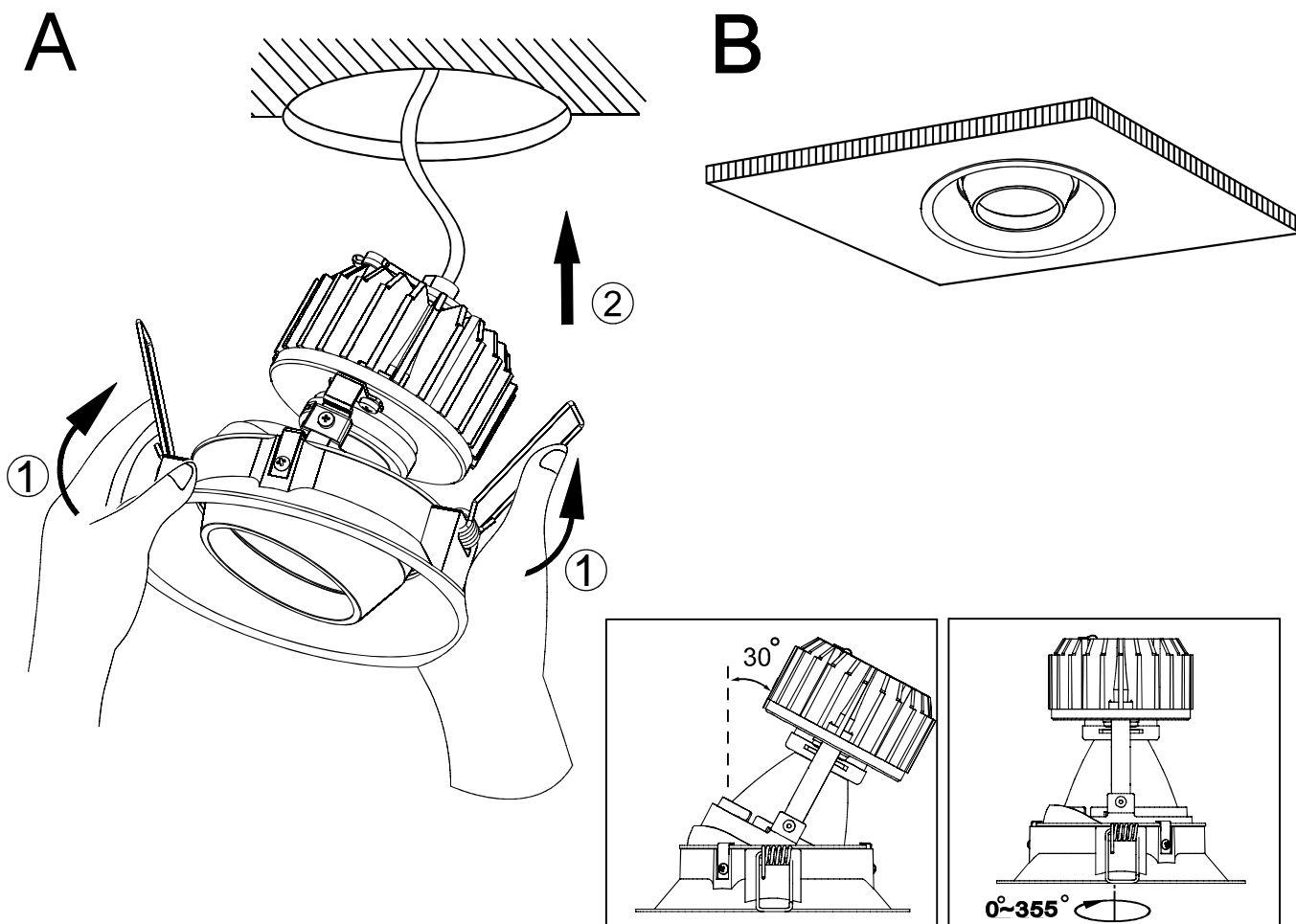

### Wiring diagram

